

Thank you for purchasing our product. Before attempting to connect or operate this product please read the instructions carefully in this manual for future use.



AV762PDIR

DESCRIPTION

AV762PDIR uses advanced imaging technology with resolution as high as 720P, CVBS 960H output, support 720P/60fps output meanwhile, self-adaptive 2D/3D noise reduction..

AV762PDIR comes with a powerful OSD menu that include motion detection, digital zoom, privacy zones, lens shading compensation, DPC, Auto electronic shutter AWB, image sharpening, etc.

PRECAUTIONS

1. Use the Appropriate Power Supply.

The input power for AV762PDIR is DC12V/AC24V. Be sure to connect it to the appropriate power. Wrong connection may cause malfunction and/or damage to the video camera.

2. Do not attempt to disassemble the camera

To prevent electric shock, do not remove screws or covers. There are no user serviceable parts inside. Any questions please ask a qualified service person for servicing.

3. Handle the camera with care.

Do not abuse the camera. Avoid striking, shaking, etc. The camera could be damaged by improper handling or storage.

4. Do not place the camera in the following locations

- ① Locations where temperature is lower than -20°C or higher than 55°C;
- ② Locations where humidity is higher than 90%;

5. Clean the CMOS faceplate with care

When cleaning the CMOS panel, do not use strong or abrasive detergents, use a piece of lens tissue or cotton tipped applicator and ethanol.

6. Do not attempt to aim the camera at the sun.

Do not attempt to aim the camera at the sun or other extremely bright objects, that cause smear to appear irrespective of whether the camera is operating or not. This can damage the CMOS (Complementary Metal Oxide Semiconductor).

7. Do not put the camera in a place with interference.

When this camera is installed near the equipment like wireless communication device that emits strong electromagnetic field, some irregularity such as noise on monitor screen may happen.

FEATURES

1. Sony 720P CMOS sensor
2. CVBS 960H output, support 720P/60fps output meanwhile
3. High resolution, 720P true color recovering
4. Self-adaptive 2D/3D image denoising
5. DC12V/AC24V duplicate supply design
6. Waterproof: IP66
7. simple operation
8. OSD menu

PARTS INSTRUCTION

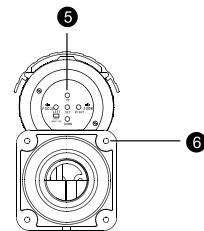
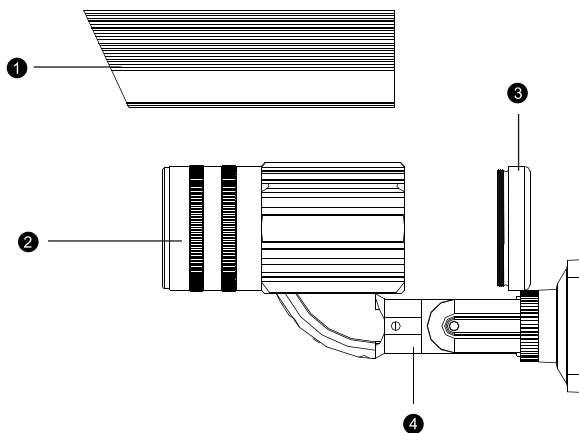

1. Hood
2. Camera body
3. Back cover
4. 3-axis bracket
5. OSD (take off the back cover)
6. Four install screws holes (at bottom of the bracket)

Setup

■ Camera installation

1. Using the foam pat to locate holes in the wall
2. Drill 4 holes in the position needed in accordance with the installation hole on the subpanel of the bracket, push the expansion bolt inside then tighten the screws, make the installation hole aim at the four screws and fix it.
3. Get the wire out from the bottle of the bracket.

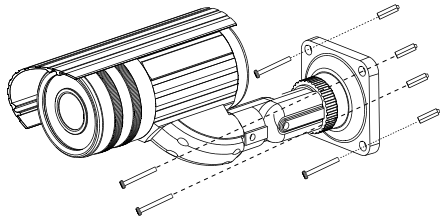

■ Assembly instruction of 3D cable bracket

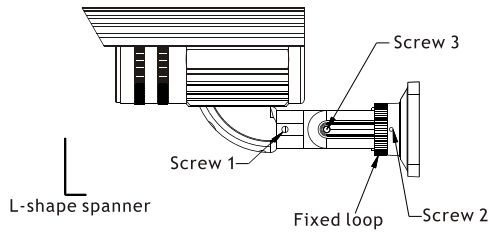

Figure 1

Figure 1: Take the screws out of the accessories pouch and use L-shape spanner to assemble.

■ Adjustment instruction of 3D bracket

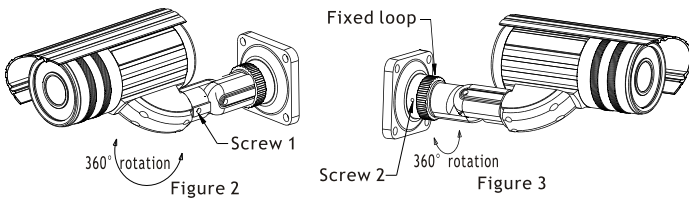

Figure 2

Figure 3

Figure 2, loosen the screw 1 to rotate 360°

Figure 3, loosen the screw 2 and the fixed loop to rotate 360°

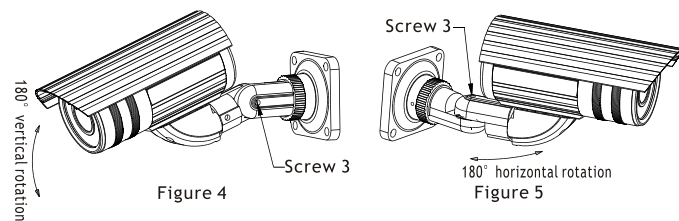
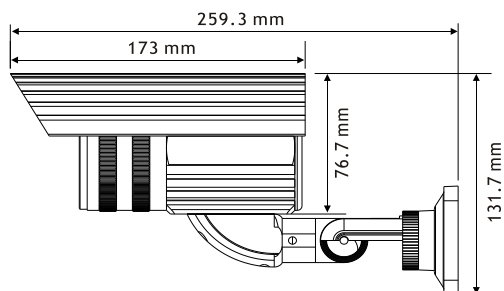

Figure 4

Figure 5

Figures 4 and 5, loosen the screw 3 to rotate 180° from up to down or from left to right

Appearance size



Menu operation

In camera the key to set the camera

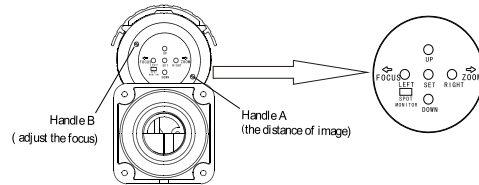

OSD function set:

SET: choose function or back to last level.

Up/down: Up or down to move vertically.

Left/right: to move left or right horizontally or modify parameters

Main menu

IMAGE	3D-NR	IR IS
	AE MODE	WB
	IMAGE ENHANCE	MIRROR
	FLIP	BRIGHTNESS
DAY&NIGHT	ZOOM IN	
	AUTO	COLOR
ZONE MASKING	B&W	EXTERNAL
	STATUS	HORIZONTAL SIZE
	VERTICAL SIZE	HORIZONTAL MOVE
MOTION DETECTION	VERTICAL MOVE	
	STATUS	COLOR
	HORIZONTAL SIZE	VERTICAL SIZE
VIDEO STANDARD	HORIZONTAL MOVE	VERTICAL MOVE
LANGUAGE	PAL	NTSC
LOAD DEFAULT	English	Chinese
SOFTVERSION		
SAVE&EXIT		

Specifications

Sensor	1/3" SONY CMOS 1.3M pixels
Output format	PAL: 960(H)*576(V) NTSC :960(H)*480(V)
Scanning system	1:1 progressive scanning
Sync. System	Internal
Resolution	720P
Lens	2.8-12mm
O.S.D	Built-in
White balance	AWB-PRO/AWB-TEMPORA AWB-AI/AWB-GW/AWB-CCT
BLC	ON/OFF/AUTO
NR	3D noise reduction
Mirror function	ON/OFF
Image adjustment	Contrast/Sharpness/Saturation
Motion detection	Off/on(4 areas)
Privacy zones	Off/on(8 areas)
Day & night	Auto / B/W / Exton / Color
S/N ratio	more than 50dB (AGC off)
Electronic shutter	Auto
Video output	1.0Vp-p composite video output, 75 Ω
IR LED	36 Units infrared LED(Φ5mm/850nm)
IR distance	100 feet
Min. Illumination	0 Lux(IR on)
Power supply	DC 12V/AC24V(± 10%)
Power consumption	DC12V/320mA, AC24V/4W
Operation temperature	-20℃~55℃
Dimension	76.7x131.7x259.3mm
Weight	950g

* Specifications are subjected to change without notice.